



Town of Stow
PLANNING BOARD

**380 Great Road
Stow, Massachusetts 01775-1122**

(978) 897-5098
FAX (978) 897-4534

August 5, 2009

NOTICE OF PUBLIC HEARING

The Stow Planning Board will hold a public hearing on September 22, 2009 at 7:30 PM in the Stow Town Building, 380 Great Road, Stow, MA to consider modification to the Definitive Subdivision/Planned Conservation Development Plan entitled Wildlife Woods **to clarify the intent of the Open Land Parcels.** The land is located in Stow, MA on the southerly side of Sudbury Road between Kingland Road and North Shore Drive as shown on Property Map Sheet R-25 as Parcel 2A-1A, 2A-2A, 2A-3A, 2A-4A, 2A-4A, 2A-B, 2A-C, 2A-D, 2A-3, and 2A-F. Plans may be viewed at the Office of the Planning Board or the Office of the Town Clerk during normal business hours.

Kathleen Willis, Chairman

2X The Stow Paper, September 2, 2009 and September 9, 2009

Wildlife Woods Subdivision Open Space Parcels

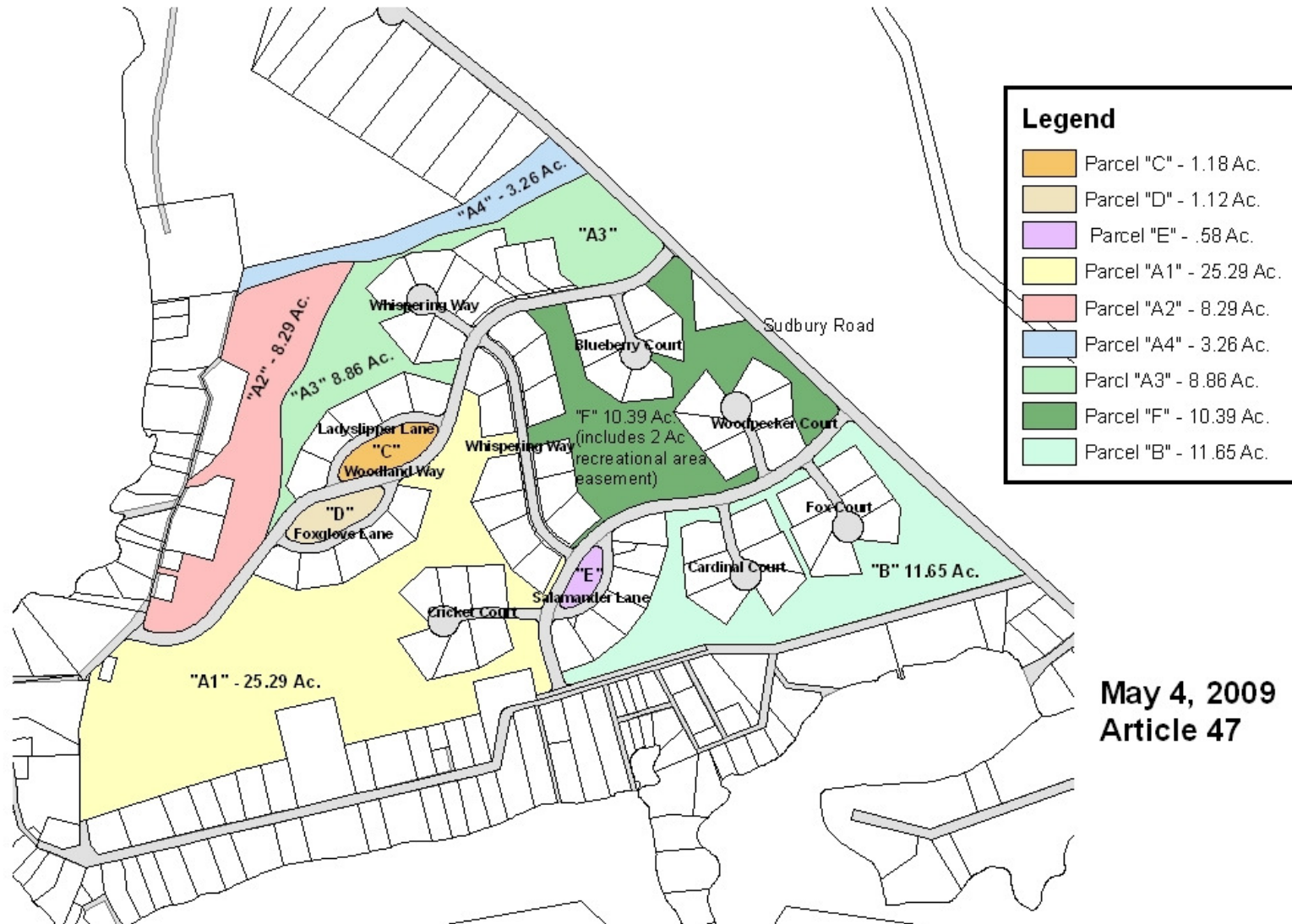

May 4, 2009
Article 47